

CONCRETE MIXER TRUCK

siti



Concrete Mixer Truck



Drum made of sheet steel high-resistance, steel flange and steel roadway ring forged, machined after assembly to ensure perfect alignment.

1 The best hydraulic set (reducer, motor and hydraulic pump) available on the market.

2 Cylindrical ring produced with special material and process for greater durability.

3 The only one on the market manufactured with a system of double support rollers on each side (04 pieces in total) mounted on top-notch bearings with seals.

4 Ladder with non-slip steps and expanded sheet metal platform, which is also easier to clean.

5 Discharge hopper with closed design, preventing leakage of material.

6 Cooling system through an oil tank coupled to the side of the water tank, with a forced ventilation radiator automatically activated by a thermostat.

7 Reservoir with capacity for 600 liters of water, pressurized with 5 kg/cm², with safety valve, water volume register by hydrometer with reading from 0 to 500 liters and hose for washing.

8 System with pressure regulator with water reservoir composed of a pressure regulating valve, manometer and on/off valve.

9 Concrete mixer chassis manufactured in highly rigid tubular profile reducing material accumulation and customized, according to the truck model.

10 Chassis manufactured in a single piece, avoiding assemblies and screws, adding greater stability to the equipment.

11 Hydraulic pressure gauge for checking the slump ratio of the concrete.

12 Rear bumper with INMETRO approval.

Specifications

MODEL		ST05	ST7	ST8	ST10
Drum Load capacity	M ³	5	7	8	10
Drum Geometric Volume	M ³	9,3	11,8	13,1	15
Maximum Drum Rotation	rpm	16	16	16	16
Water tank*	Liters	600	600	600	600
Total Oil Reservoir	Liters	60	60	60	60
Operating Oil Volume	Liters	30	30	30	30
DIMENSIONS		ST05	ST7	ST8	ST10
Total Length (A)	mm	6200	6250	6450	6700
Chassis Length (C)	mm	5200	6100	6100	6250
Total Height (B)	mm	2500	2475	2760	2750
Center of Gravity (loaded) (S)	mm	1800	2225	2391	3019
Drum Diameter (D)	mm	2250	2250	2250	2250
Roller Diameter	mm	250	200	200	200
Drum Angle (E)	----	15°	15°	14°	11°
Structure Weight (empty)	Kg	4000	4100	4200	4300

*Other options on request.

**Reference values, subject to change without prior notice.

***Dimensions may vary by truck model.

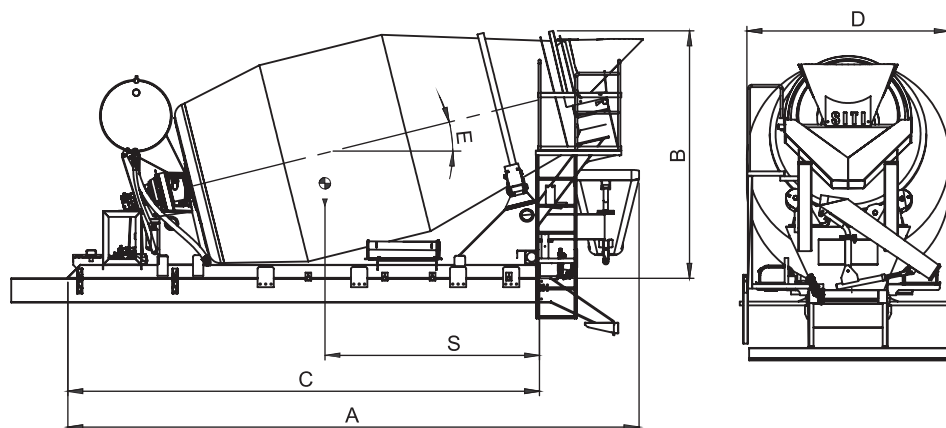

Mixing Blades

Longa Vida

The "Longa Vida" (meaning 'long life') mixing blades and reinforcements are built with high performance materials, ensuring durability with less weight.

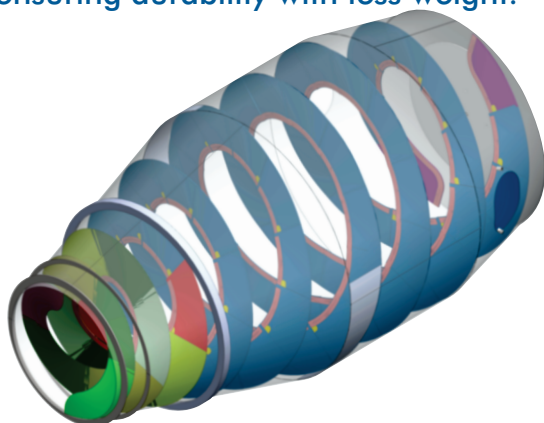

Painting

The concrete mixers are fully blasted and painted in polyurethane paint type background/finish with application of several coats, according to the SITI quality standard, following the colors and logo of each client.



Concrete Mixer Truck Reformation



With more than 30 years of experience in the concrete mixer market, we guarantee a quality renovation. Our restoration process includes steel shot blast preparation, which removes practically 100% of the impurities on the sheet surface and increases the durability of the painting.

TYPES OF REFORMATION



COMPLETE



PARTIAL



BEFORE

AFTER



Suécia Avenue, Jd. Santa Terezinha – Mogi Guaçu City – São Paulo State
ZIP CODE 13848-315 | Brazil

Phone: +55 (19) 3891-9700 | E-mail: siti@siti.com.br | Website: www.siti.com.br